

SPARKELEC®

SMART CURTAIN  
ZIGBEE WALL SWITCH

User Manual

  
Zigbee 3

Tempered Glass Wall Switch



TOUCH



APP CONTROL



POWER MONITORING

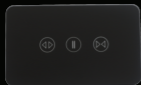

Available in Matte White  
and Matte Black Colours

## Features

- 1 High quality tempered glass panel design, always look as new.
- 2 With RGB LED indicator, you can change the colour by APP.
- 3 Child lock.
- 4 Turn on/off backlight
- 5 Percentage adjustment curtains
- 6 Multiple themes selection (Dark/Light)
- 7 Support Amazon Alexa and Google Assistant, etc.

## Installation

- 1 Open the front cover by a small flat screwdriver

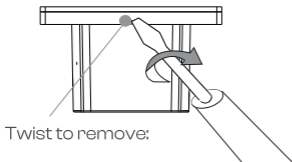

Or magnetic opening installation

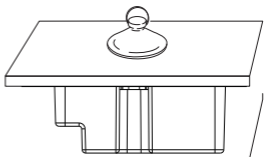

- 2 Wiring diagram  
Connect wire to the correct terminal and tighten the screws.

Neutral

Active

Forward  
Reoted

Motor

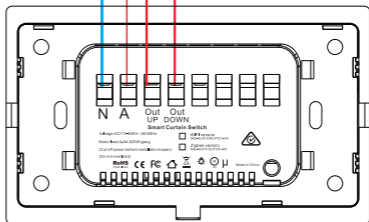
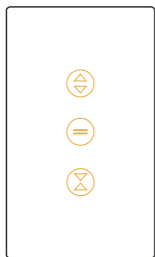

### 3 Fix screws



72mm

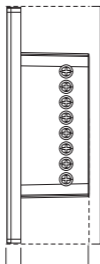

8mm 34mm

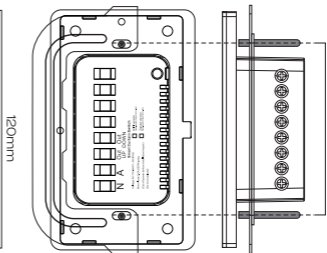

85mm

#### 4 Cover the panel and connect the power.

Make sure to use our original screws or use cross shaped flat head screws.

Do not fix the screws too tight, as too tight will cause the shell to deform and it will not work.

After the glass panel is covered, please check whether it is tightly attached to the bottom shell. if not the switch wont work.

Turn on general power

Other screws



Cover the glass panel

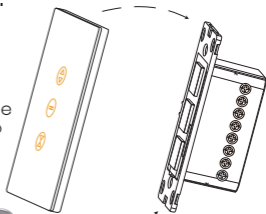

Push until click

#### Attention:

If you are touch testing without the glass panel cover on, please turn off general power after testing, then put on glass panel cover to switch and turn on general power again

### Connect Your ZigBee Hub

Ensure your ZigBee Hub is connected to the nearest ethernet port with internet access.

### Download & Register the APP

Please download the free app from the App store or Google Play store, or scan the QR code below.



Scan Me



Scan Me



Open the Sparkelec Smart Home App. For new users, register a new account or if existing user. Login with your user name and password.

### Add your Smart Switch to your App

- 1 Arrange installation of your smart switch by a licensed electrical contractor (refer installation instructions at start of this manual).
- 2 Once safely wired and powered on, Click any button five times consecutively and rapidly then hold the button for 5 seconds until the buttons start to blink rapidly.
- 3 Open "Sparkelec Smart Home App", Click top right "+" Then choose "Electricain" -- "Switch(BLE+Wi-Fi)" or turn on mobile bluetooth, it will search the device automatically

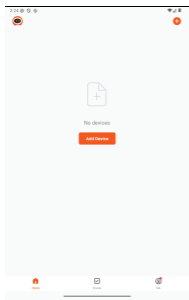

Add the device

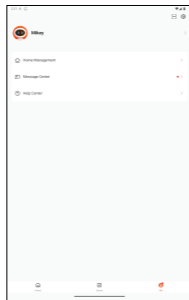

Search the device

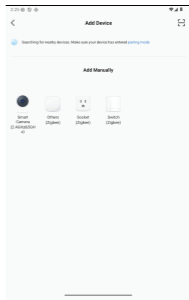

Find the device

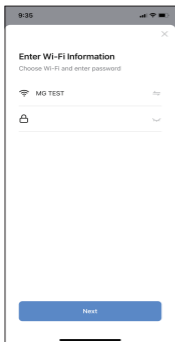

Enter password

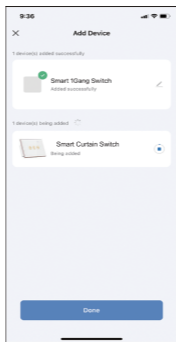

Finished

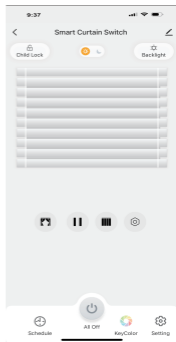

Open/Close the curtain

## Add Zigbee switch to your App

- 1 Use the cable wire to connect the gateway and router
- 2 Open "Sparkelec Smart Home App", Click top right "+"
- 3 Choose "Gateway and others" and choose the "gateway" click next until finished



Zigbee gateway

- 4 Press any button 5 times, the LED indicator will be flashing. Open "Sparkelec Smart Home App", Click top right-hand "+", add "Electrician", Choose the "Switch(zigbee)", Click next and choose the gateway, Step by step until finished. Or choose "Smart Gateway", Click "Add subdevice "--" LED already blink, Search device, Then step by step until finished.



Enter your password

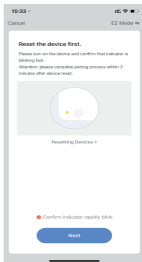

Connection will now begin

# Feature Introduction

## 1 Curtain Type :

Roller Blind or Venetian Blind

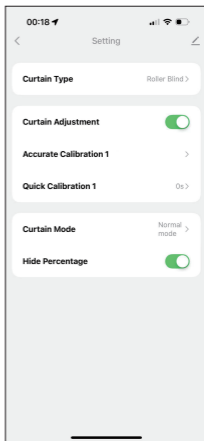
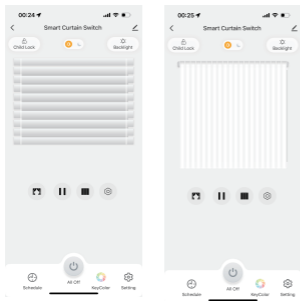

## 2 Curtain Adjustment:

you can adjust the curtain's tilting (depend on the curtain)

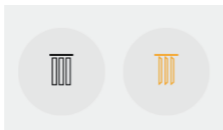

### 3 Accurate Calibration 1:

The total working time of the curtains is 120 seconds.

Just click "Accurate calibration", They will calibrate by itself.

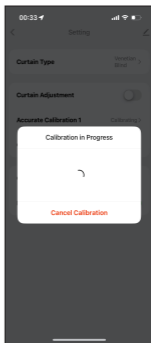
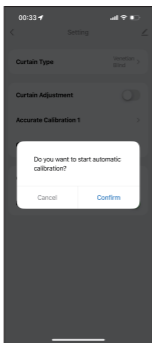

### 4 Accurate Calibration 2:

Only enter time

Curtain will work on this time.

#### Attention:

They curtain will not full open/close if you don't calibration

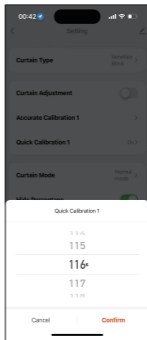

## 5 Curtain Mode: Normal and Safe Mode

### Normal Mode:

When you touch the "Open" or "Close" button, Curtain work directly.

### Safe Mode:

When you touch the "Open" button Curtain work directly.

If you want to close the curtain you need to long press the button until the curtain full close.

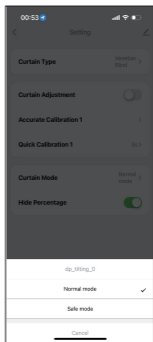

## 6 Hide Percentage

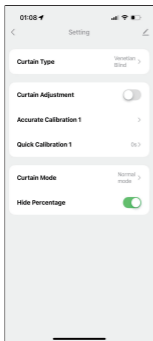

Hide

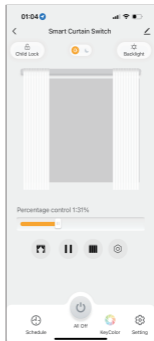

Display

## Other functions



Adjust RGB backlight

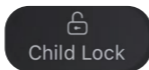

Child lock

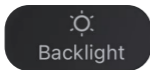

Turn on/off  
backlight



Multiple Themes  
selection (Dark/Light)

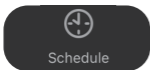

Schedule

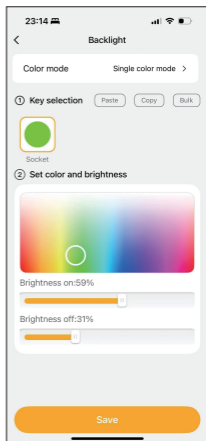

## How to connect Alexa and Google Assistant

Add the Smart Curtain Switch to Alexa/Google Assistant following this instructions below:

Open Sparkelec Smart Home App, go to "Profile" ->

"Integration, tap "Alexa" or "Google Assistant" and install

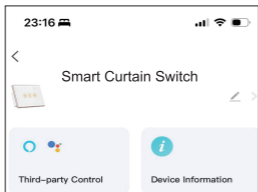

1. Third-party Control

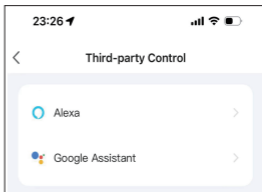

2. Choose Alexa



3. Link to Alexa

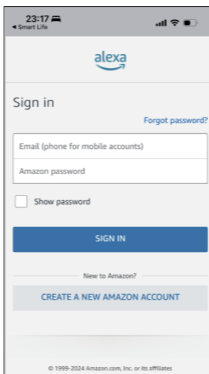

4. Enter account

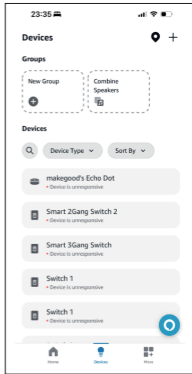

5. Devices list

## Specification

Dimension	Voltage
120*72*42mm or 124*78*43,5mm	110-240V AC/50~60Hz
Frequency	Motor Load
Zigbee 3	Max 2,6A, 625W/gang
Wifi version Model NO	Zigbee version Model NO
SCW-WHITE/BLACK	SCW-WHITE/BLACK

## Warning

- 1 To prevent injury, this apparatus must be installed by a Licensed Electrical Contractor.
- 2 For indoor used only.
- 3 Please make sure the curtain is not overloaded.

## **Warning**

This warranty covers defects in manufacturing that arise from the correct use of the device. It is limited to defects in materials or workmanship and does not cover damage caused by abuse, misuse, unauthorised modification, power surge damage or extreme heat or cold or corrosive environments.

The warranty also does not cover the normal wear and tear on covers, cases, housings, connectors and accessories. The warranty does not apply to any product with missing, altered or defaced serial numbers. Your products come with a 24 months manufacturer's warranty as standard.



Product Manufactured & Distributed by Sparkelec Pty Ltd.