

# BC 1800W Dolphin Hot Air Hand Dryers

## User Manual

Please read carefully before use

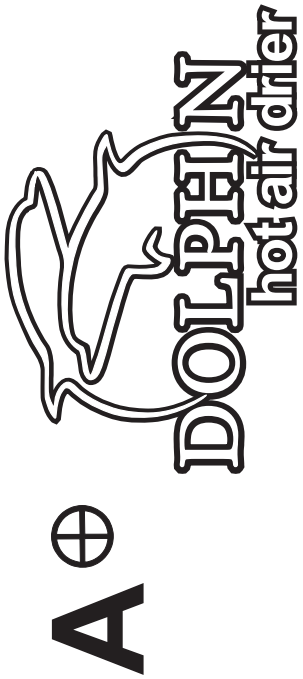



# Mounting Instructions

This product intended for installation by a qualified service person using 1.2 mm<sup>2</sup> solid conductor for wiring.

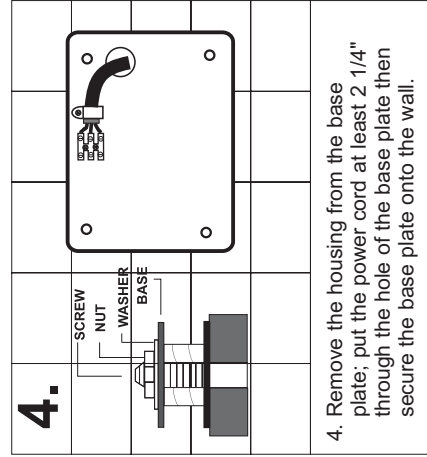
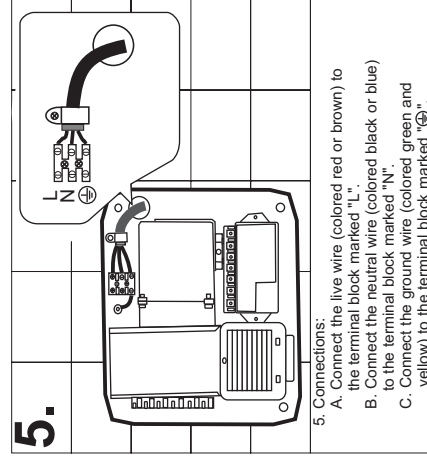
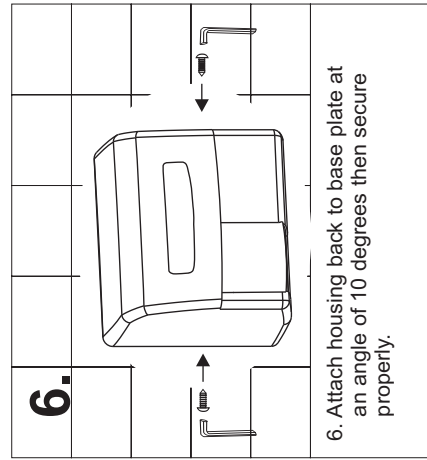
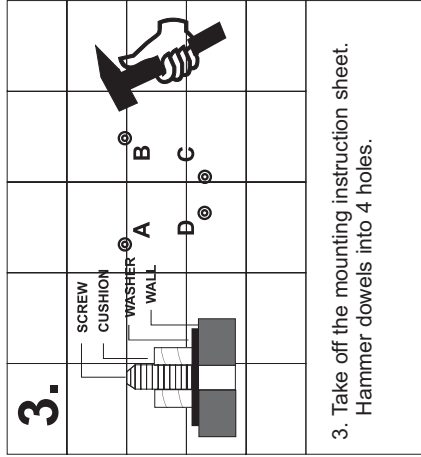
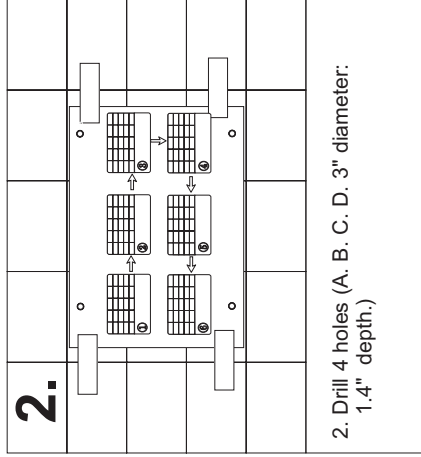
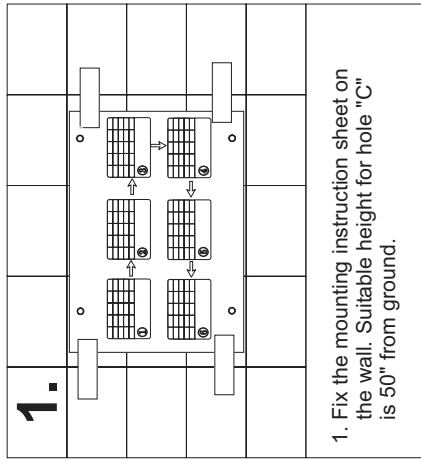

A ⊕

⊕ B

C ⊕

D ⊕

130 cm (50") FROM THE GROUND IS SUITABLE