

Sunset switch with in-built timer



Product Code: SSS

Instructions

Specifications:

Voltage: 220-240V/AC

Rated Current: 16A

Working Temperature: -20~+40°C

Built-in Timer: 1, 2, 3, 4, 5, 6, 7, 8 & 9 Hours

Power Frequency: 50/60Hz

Ambient Light: <3-500LUX (adjustable)

Working Humidity: <93%RH

IP Rating/Class: IP66

Function:

- **LUX** setting: turn LUX knob anti-clockwise to “3” position, the photocell will only work in the dark (less than 3 LUX). If you turn clockwise to “500” position, it will work when the ambient light is less than 500LUX.
- **TIME** setting: set the regular working hours of the photocell as needed

Installation:

- Disconnect the power.
- Loosen the four screws on the cover and remove the front cover (figure1).
- Remove the end cap on the side and connect the wire as per wiring diagram (figure2).
- Use the attached accessories to seal with conduit glue (refer to figure 3 & 4)
- Install the 5 end caps included in the product as per (refer to figure 5).
- Tighten the base of the product with the enclosed screws and insert the screw caps (refer to figure6). Make sure the screws are tight and not loose (onto the base)
- Mount the back the cover with enclosed screws and the screw caps (refer to figure7).
- Switch on the power, and then test.

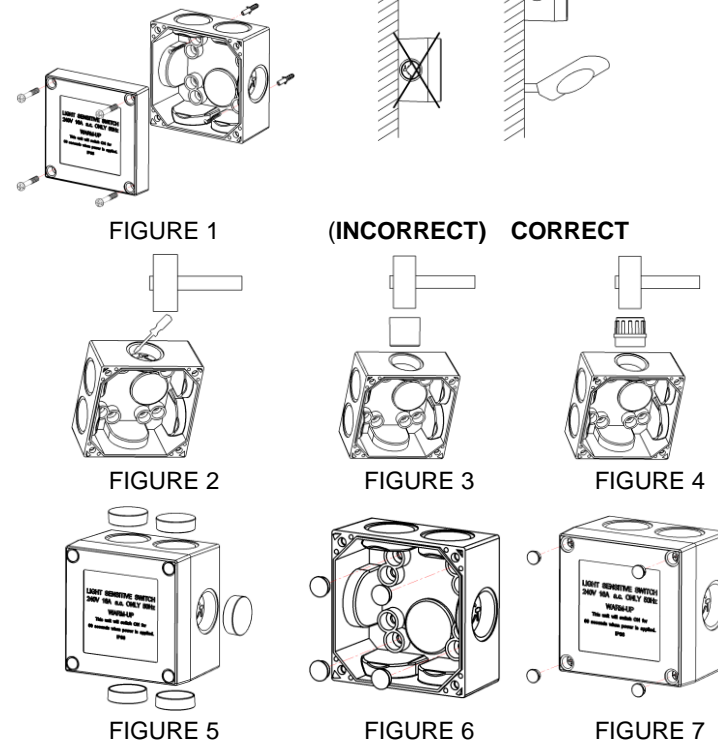

Connection wiring diagram

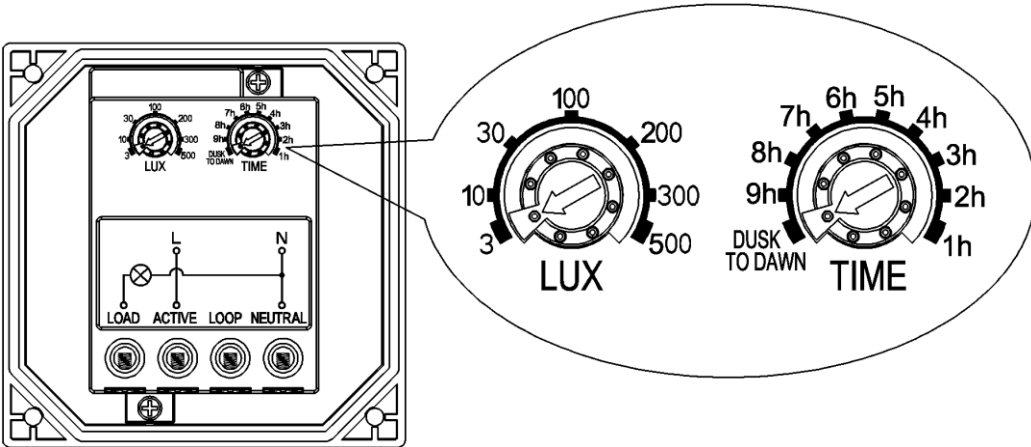
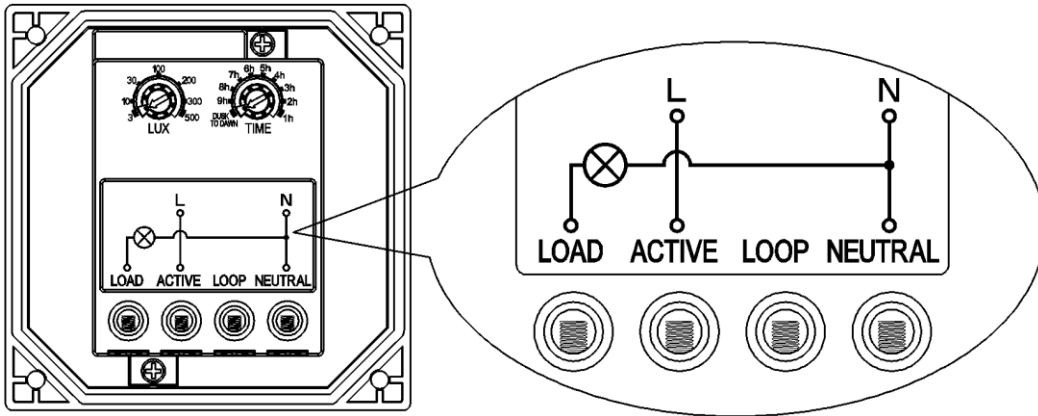

Time setting:

The LED indicator inside the sensor will flash to display the preset times as following:

- | | |
|--------------------------------------|--|
| 1) 1 hour: flash one time | 6) 6 hours: flash six times |
| 2) 2 hours: flash two times | 7) 7 hours: flash seven times |
| 3) 3 hours: flash three times | 8) 8 hours: flash eight times |
| 4) 4 hours: flash four times | 9) 9 hours: flash nine times |
| 5) 5 hours: flash five times | 10) dusk to dawn: rapidly flash ten times |

Test after installation:

- Set the LUX knob to “3” position and set the time knob to “1h” position. When the ambient light is less than 3 LUX, the red indicator light will turn on, after 1 minute, the lamp will turn on.

- 1) In 1 hour, Ambient light < 3 LUX:

The lamp will hold on lighting for 1 hour. After 1 hour, it will turn off. The red indicator light will turn off when the ambient light is more than 10 LUX.

- 2) In 1 hour, Ambient light > 10 LUX

The red indicator light will turn off, after 1 minute, the lamp will turn off.

When set the Time knob to 2-9h, please can refer to above description to test.

- Set the LUX knob to “3” position and set the time knob to “DUSK TO DAWN” position, if the ambient light is less than 3 LUX, the red indicator light will turn on, after 1 minute, the lamp will turn on and hold on lighting. Only when the ambient light is more than 10 LUX, the red indicator light will turn off, after 1 minute, the lamp will turn off.

For the product to function properly:

- In front of the photocell: there should be no objects blocking the PE Cell from getting natural light (including installing the product underneath the light)
- When the lamp is on & if another light source (e.g sunlight) is illuminated to the photocell, and this light source lasts for more than one minute, the lamp will turn off and the electronic TIMER will stop counting.
- The TIMER will recount from the beginning when the light (connected to the PE Cell) turns on again.
- The electronic TIMER will reset when the power is off over 2~5 seconds.