

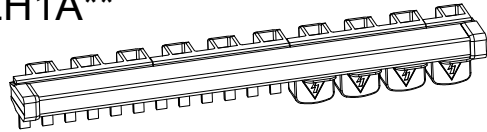

DLH1 Series Busbar Instructions

DLH1A**



DLH1B**

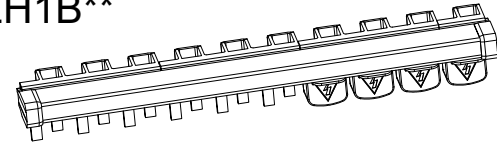

PLEASE NOTE !

- This product MUST be installed by a licensed electrician in accordance with the appropriate statutory regulations and codes of practice.
- All applicable local, regional and national regulations must be complied with during the installation, use, maintenance and replacement of this device.
- This product should not be installed if, when unpacking it, you observe that it is damaged.
- Our company cannot be held responsible in the event of noncompliance with the instructions in this document and in the documents to which it refers.
- The service instruction must be observed throughout the life time of this product.

DANGER!

- HAZARD OF ELECTRIC SHOCK, EXPLOSION OR ARC FLASH
- Turn off all power supplying this product before working on it.
- Use a voltage tester with a suitable rated voltage in order to check that all active conductors aren't energized.
- Carefully inspect the work area to check that no tools or objects could have been left inside the equipment.
- Failure to follow these instructions will result in death or serious injury.

Unboxing :

DLH1A**

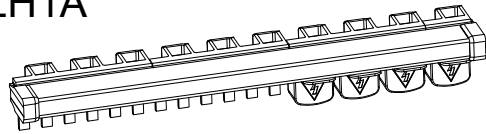

DLH1B**

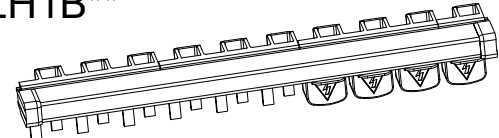

Accessories

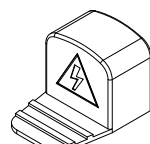

×4

Teeth Cover 4pcs

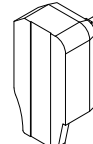

×1

End Cap 2pcs

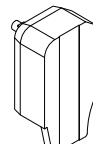

×1

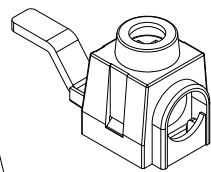

×2

Cable Connectors 2pcs

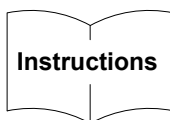

×1

Instructions

Model No. Mark Rule:

DLH1A10

DL Company

Model No.

Poles

Installation Method: A/B

A:Top feed busbar Installation method.

B:Bottom feed busbar Installation method.

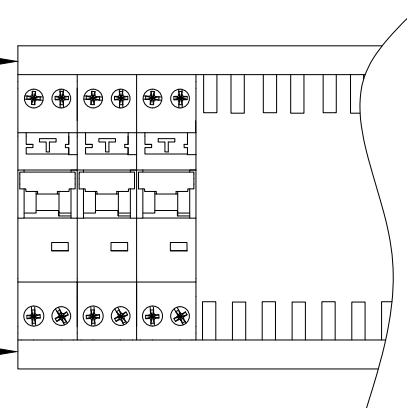

DANGER!

- HAZARD OF ELECTRIC SHOCK, EXPLOSION OR ARC FLASH
- Turn off all power supplying this product before working on it.
- Use a voltage tester with a suitable rated voltage in order to check that all active conductors aren't energized.
- Carefully inspect the work area to check that no tools or objects could have been left inside the equipment.
- Failure to follow these instructions will result in death or serious injury.

Installation Method

Top feed busbar Installation method.

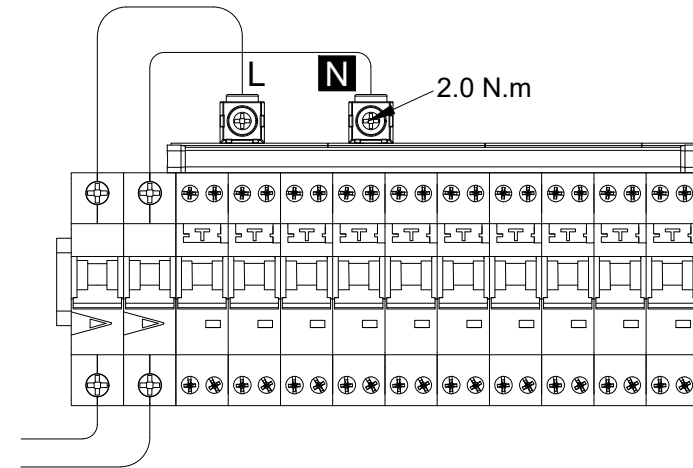

Top feed Installation mark

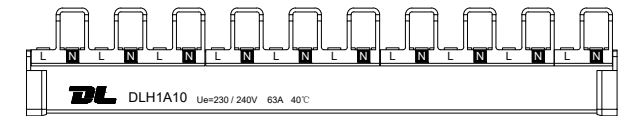

Bottom feed busbar Installation method.

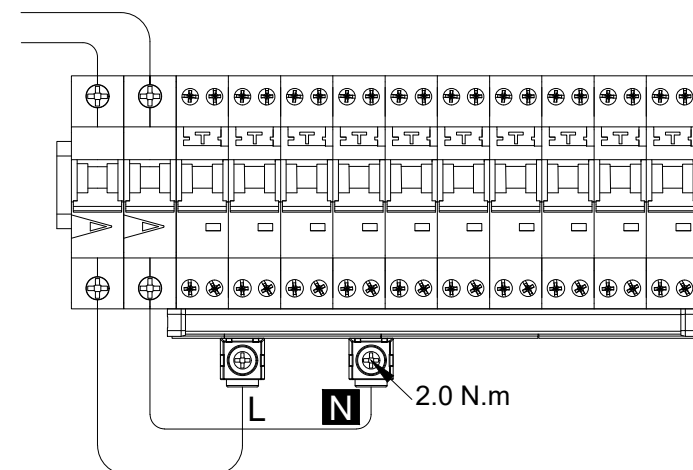

Bottom feed Installation mark

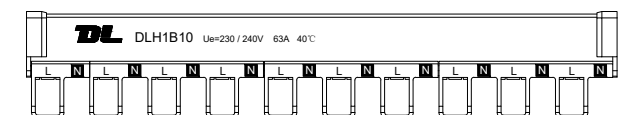

Cutting, End Cap Installation and Tooth Cap Installation

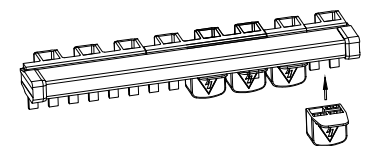
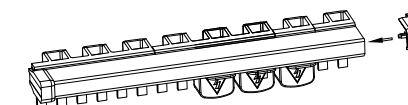
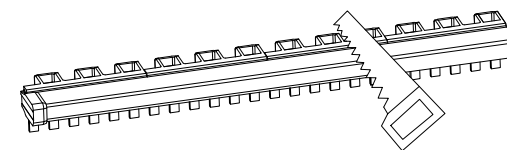

Cutable to have desired number of modules and insulate with End caps